

Map Legend		
	Building Footprint	001 Parcel Number
	Condo Unit	Unit 1 Parcel Lot Number

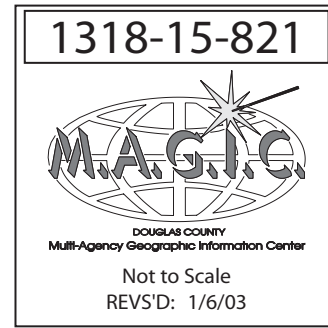

CONDO DETAIL

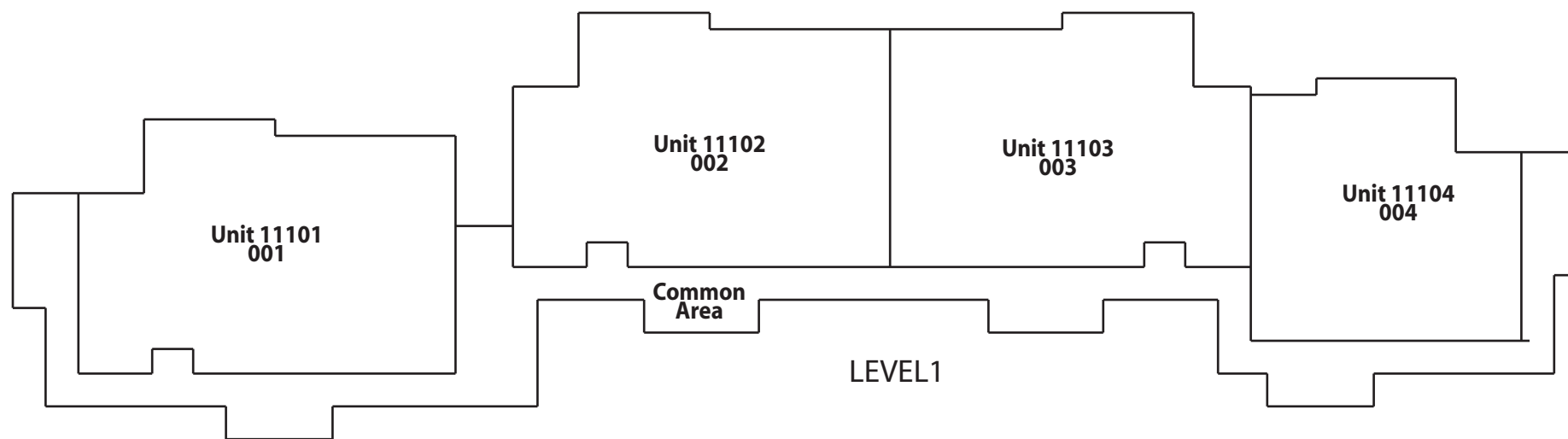
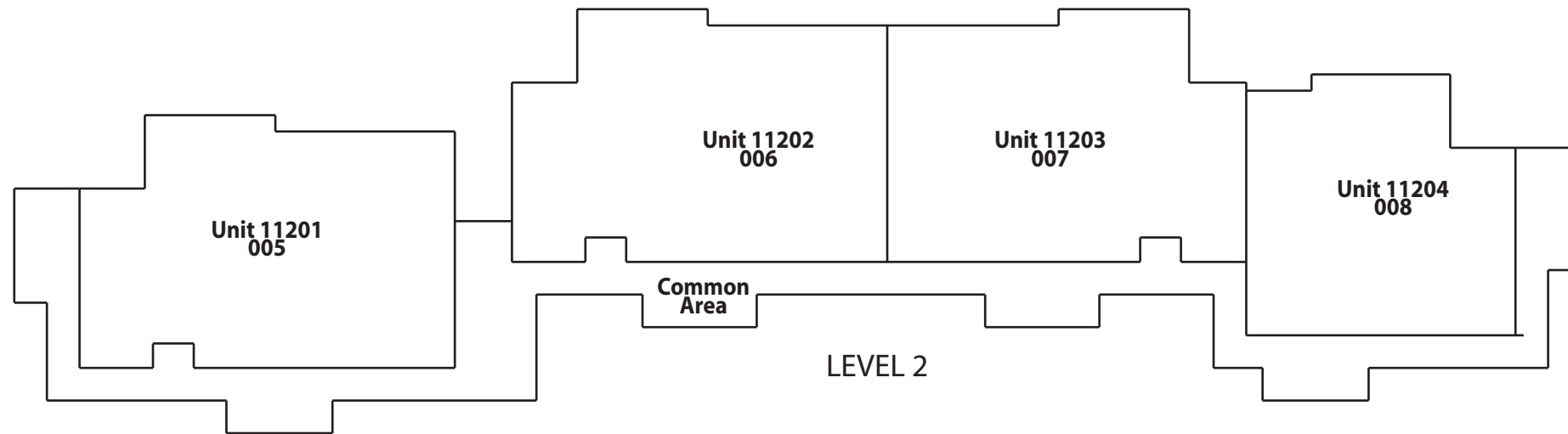

Bldg 11
South Shore

172 ELKS POINT RD

For Condo Dimensions
Refer to Record Map
Book 1202, Page 2181-Doc. 559872

NOTE: This map is prepared for the use of Douglas County Assessor, for assessment and illustrative purposes only. It does not represent survey of the premises. No liability is assumed as to the sufficiency or accuracy of the data delineated hereon.