

Douglas County, Nevada

Assessor's Parcels
Barbara Byington, Assessor

Map Legend

- Parcel Boundary
- ▬ Sub'd Boundary
- - - Road Easement
- - - - Town Boundary
- - - - Township/Range/Section

001	Parcel Number
110	Parcel Sub/Seq Number
1.00	Parcel Acreage
B L K A	Parcel Block Number
1	Parcel Lot Number
1100	Parcel Address

T13 N R20 E

SEC. 33

6	5	4	3	2	1
7	8	9	10	11	12
18	17	16	15	14	13
19	20	21	22	23	24
30	29	28	27	26	25
31	32	33	34	35	36

S 2 SW 4

1	5
2	6
3	7
4	8

1320-33-4

DETAIL
B

SCALE: Not to Scale
REVSD: 01-03-2000

NOTE: This map is prepared for the use of Douglas County Assessor, for assessment and illustrative purposes only. It does not represent survey of the premises. No liability is assumed as to the sufficiency or accuracy of the data delineated hereon.

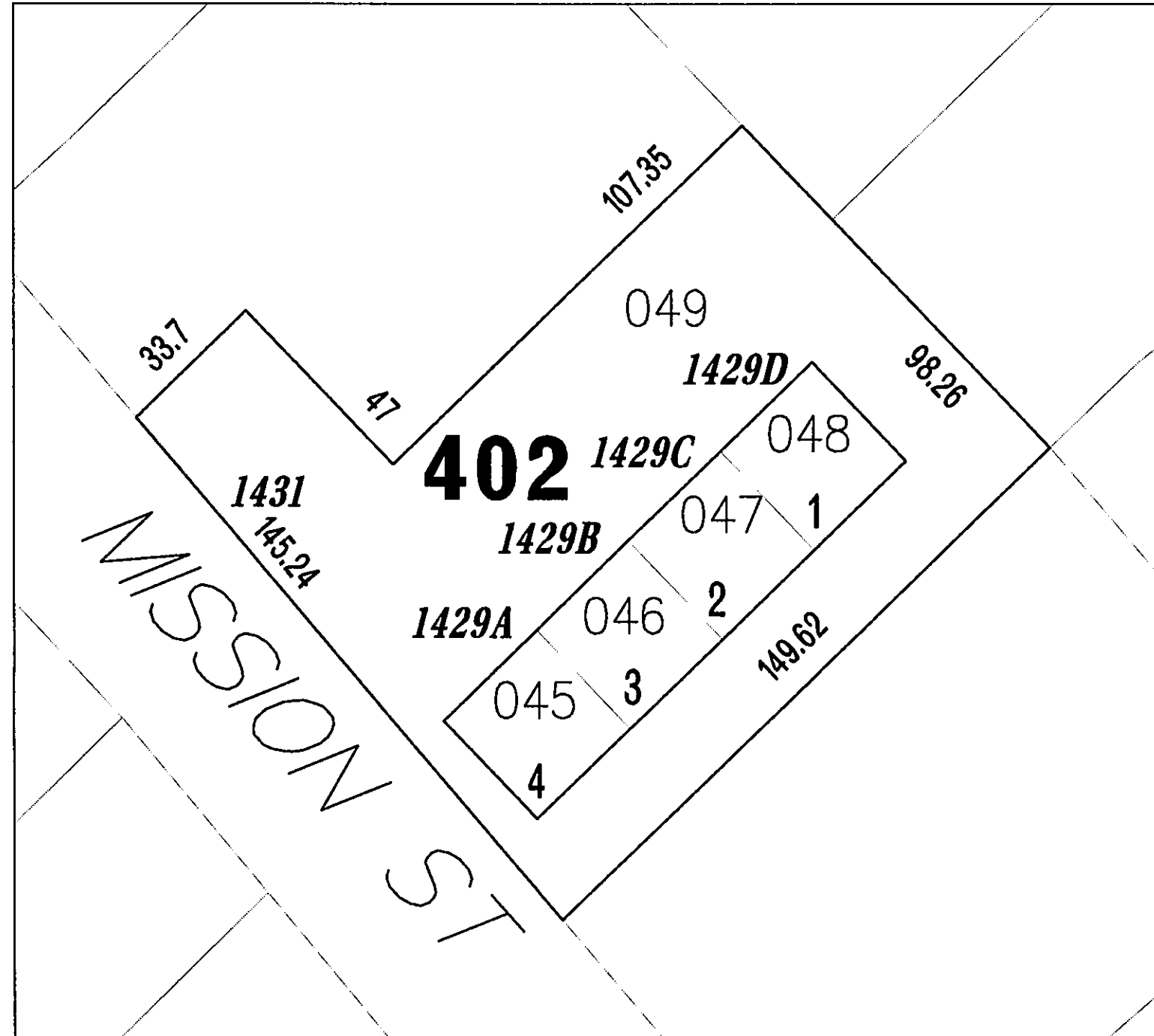

These assessment maps are the pilot project for the D. C. Assessor's new parcel mapping and numbering system. They are in a preliminary state and are subject to ongoing evaluation, corrections and addition of data. If you have any suggestions or comments on the new system or notice any discrepancies, please contact Dawn Patterson at D. C. GIS, 782-9894. (7-10-98)