

DOUGLAS COUNTY, NEVADA
Assessor's Parcels
Douglas County Assessor

Map Legend

- Parcel Boundary
- Subdivision Boundary
- Town Boundary
- Township/Range/Section
- Condo Unit
- Common Area

001 Parcel Number
110 Parcel Sub/Seq Number
1.0 Ac Parcel Acreage
B L K A Parcel Block Number
1 Parcel Lot Number
1100 Parcel Address

T 14 N R 20 E

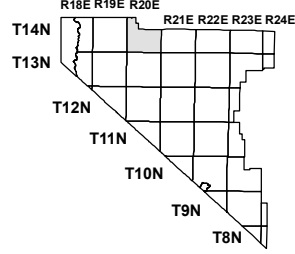

SEC. 05

6	5	4	3	2	1
7	8	9	10	11	12
18	17	16	15	14	13
19	20	21	22	23	24
30	29	28	27	26	25
31	32	33	34	35	36

**UNIT
DETAIL**

1420-05-421

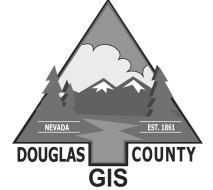

DOUGLAS COUNTY GIS
SCALE: 1" = 16'
REV'S'D: 1/11/2022

NOTE: This map is prepared for the use of the Douglas County Assessor, for assessment and illustrative purposes only. It does not represent survey of the premises. No liability is assumed as to the sufficiency or accuracy of the data delineated hereon.



LEVEL 1

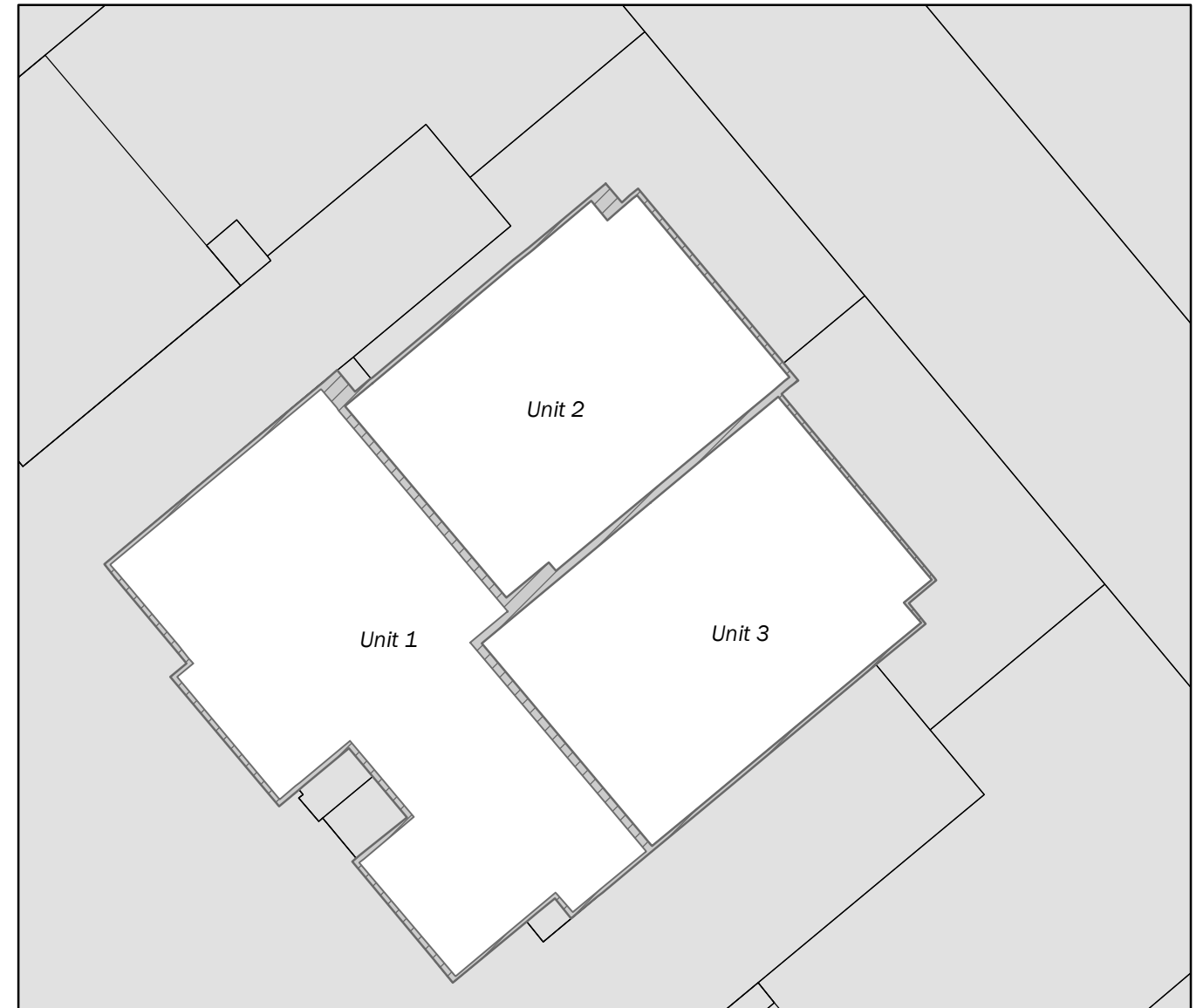

LEVEL 2

**The Commons South At Valley Knolls
Building # 11
3687 Pulsar Ln.
For Unit Dimensions
Refer to Recorded Map
Doc. 2021-978119**