

Map Legend

- Parcel Boundary
- Subdivision Boundary
- Town Boundary
- Township/Range/Section
- Condo Unit
- Common Area

001	Parcel Number
110	Parcel Sub/Seq Number
1.0 Ac	Parcel Acreage
B L K A	Parcel Block Number
1	Parcel Lot Number
1100	Parcel Address

T 14 N R 20 E

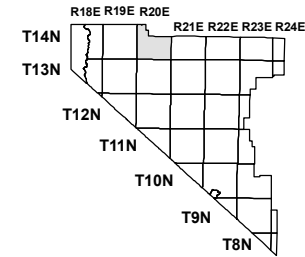

SEC. 05

6	5	4	3	2	1
7	8	9	10	11	12
18	17	16	15	14	13
19	20	21	22	23	24
30	29	28	27	26	25
31	32	33	34	35	36

**UNIT
DETAIL**

1420-05-426

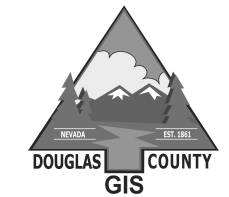

SCALE: 1" = 18'
REV'S'D: 1/11/2022

NOTE: This map is prepared for the use of the Douglas County Assessor, for assessment and illustrative purposes only. It does not represent survey of the premises. No liability is assumed as to the sufficiency or accuracy of the data delineated hereon.



LEVEL 1

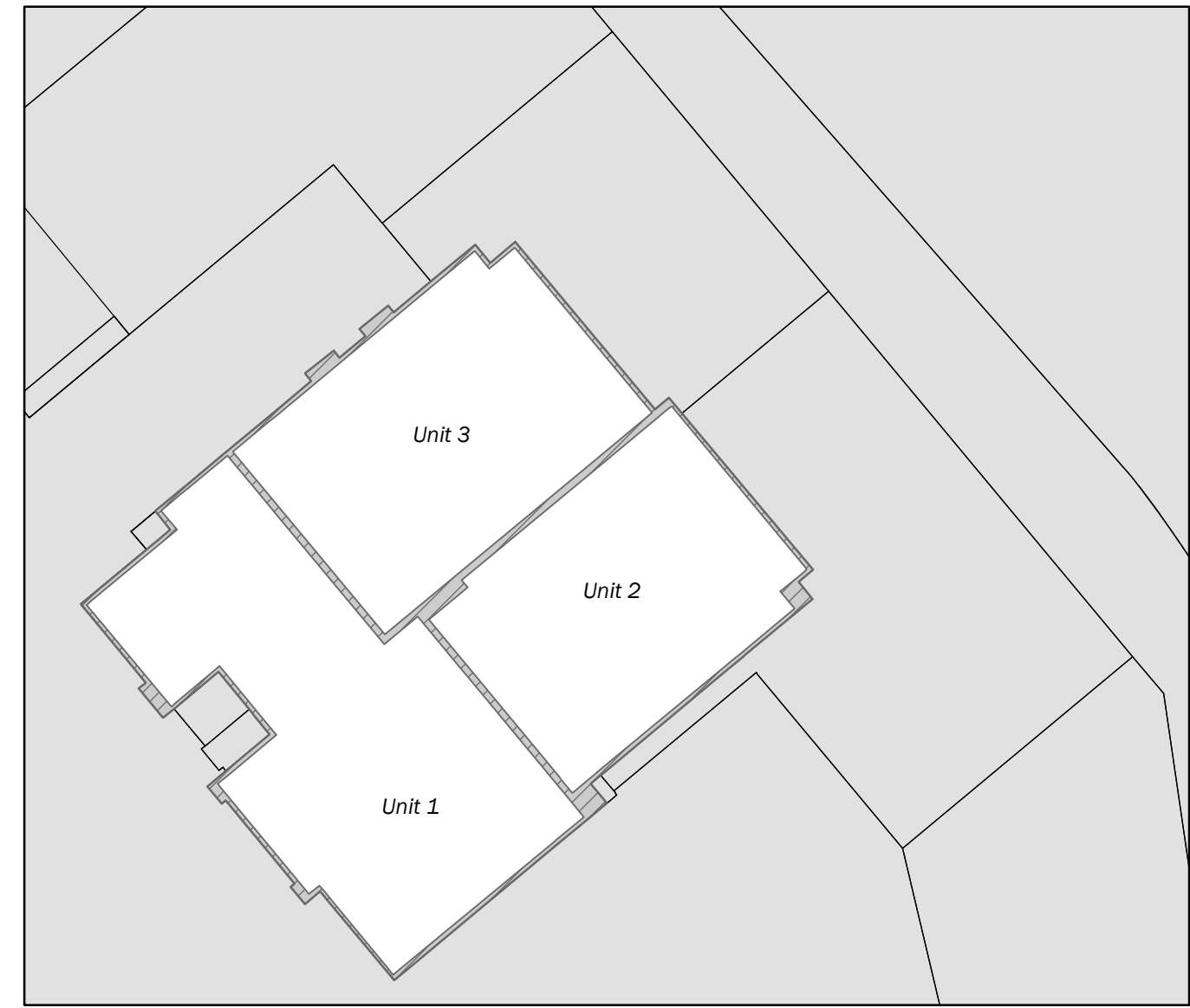

LEVEL 2

**The Commons South At Valley Knolls
Building # 16
3637 Pulsar Ln.
For Unit Dimensions
Refer to Recorded Map
Doc. 2021-978119**