

**Map Legend**

- Parcel Boundary
- Subdivision Boundary
- Town Boundary
- Township/Range/Section
- Condo Unit
- Common Area

- 001 Parcel Number
- 110** Parcel Sub/Seq Number
- 1.0 Ac Parcel Acreage
- B L K A Parcel Block Number
- 1 Parcel Lot Number
- 1100 Parcel Address

**T 14 N R 20 E**

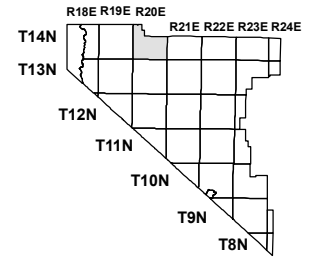

**SEC. 05**

6	5	4	3	2	1
7	8	9	10	11	12
18	17	16	15	14	13
19	20	21	22	23	24
30	29	28	27	26	25
31	32	33	34	35	36

**UNIT  
DETAIL**

**1420-05-427**

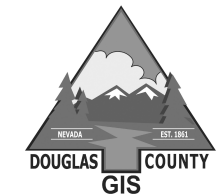

SCALE: 1" = 18'  
REV'S'D: 1/11/2022

NOTE: This map is prepared for the use of the Douglas County Assessor, for assessment and illustrative purposes only. It does not represent survey of the premises. No liability is assumed as to the sufficiency or accuracy of the data delineated hereon.



**LEVEL 1**

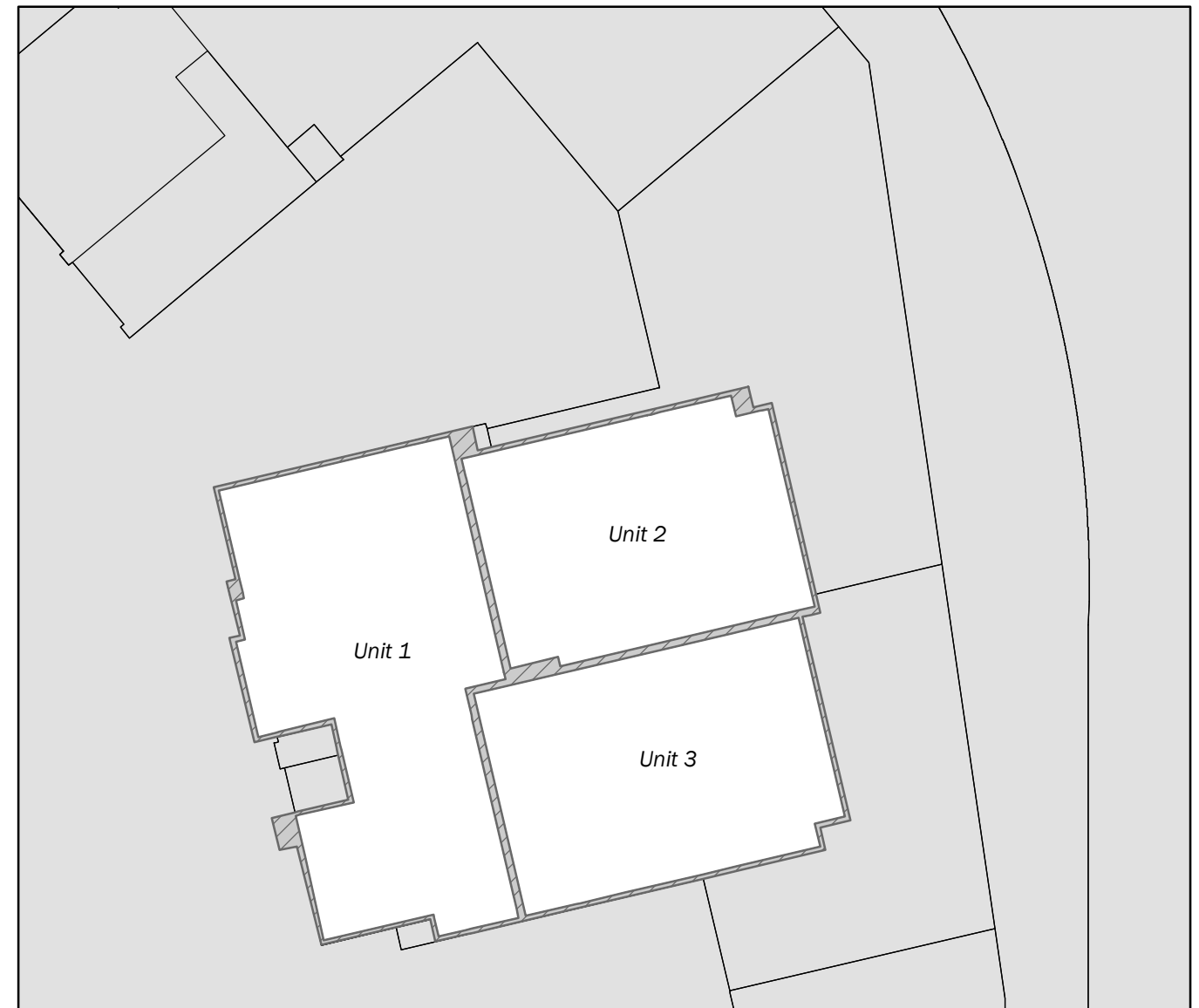

**LEVEL 2**

**The Commons South At Valley Knolls  
Building # 17  
3631 Pulsar Ln.  
For Unit Dimensions  
Refer to Recorded Map  
Doc. 2021-978119**